

Section II.

TM 9-2320-280-24P-1

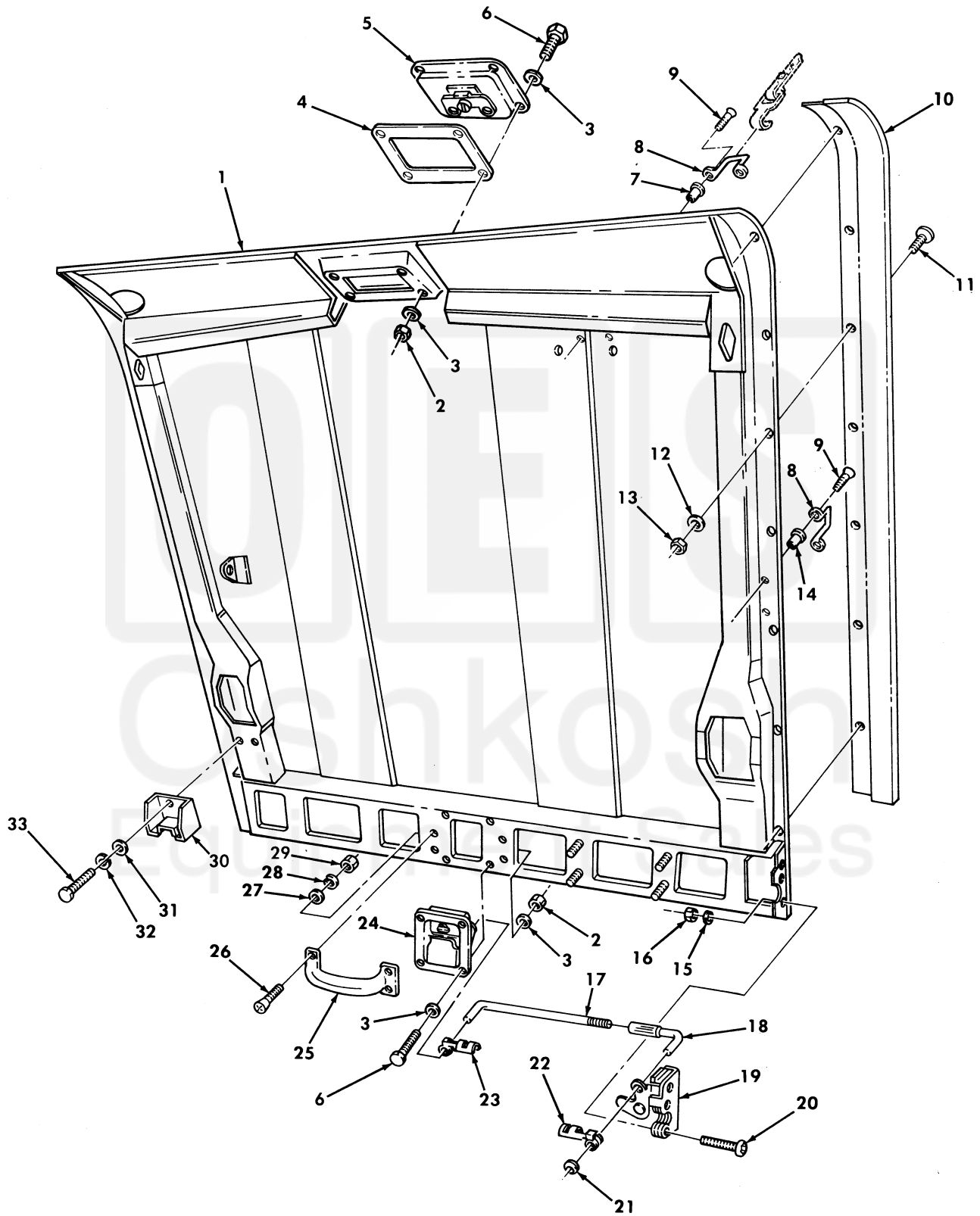

Figure 269. Cargo Shell Door Assembly, Basic and Supplemental Armor.

Current part is item (19) on diagram. Available at www.oshkoshequipment.com

SECTION II		TM9-2320-280-24P					
(1)	(2)	(3)	(4)	(5)	(6)	(7)	
ITEM NO	SMR CODE	NSN	CAGEC	PART NUMBER	DESCRIPTION AND USABLE ON CODES(UOC)	QTY	
13	PAOZZ	5310000614650	96906	MS51943-31	NUT, SELF-LOCKING, HE 1/4-20.....	26	
					UOC:A11, A24, A27, B24, H11, H24, H27, MMM		
14	PAOZZ		78276	ALS4-1024-225	INSERT, SCREW THREAD.....	2	
					UOC:C17		
15	PAOZZ	5310004079566	96906	MS35338-45	WASHER, LOCK 5/16.....	12	
					UOC:A11, A24, A25, A26, A27, B17, B18, B24, B25, C17, H11, H17, H18, H24, H25, H26, H27, MMM		
16	PAOZZ	5310008140673	96906	MS51943-33	NUT, SELF-LOCKING, HE 5/16-18.....	12	
					UOC:A11, A24, A25, A26, A27, B17, B18, B24, B25, C17, H11, H17, H18, H24, H25, H26, H27, MMM		
17	PAOZZ	5306011950277	34623	5583141	BOLT, HOOK.....	4	
					UOC:A11, A24, A25, A26, A27, B17, B18, B24, B25, C17, H11, H17, H18, H24, H25, H26, H27, MMM		
18	PAOZZ	5340011972736	19220	16386(75)	ROD END, THREADED.....	4	
					UOC:A11, A24, A25, A26, A27, B17, B18, B24, B25, C17, H11, H17, H18, H24, H25, H26, H27, MMM		
19	PAOZZ	5340011996103	19220	3-400-R	LATCH, DOOR R. H. FRONT, LEFT REAR.....	2	
					UOC:A11, A24, A25, A26, A27, B17, B18, B24, B25, C17, H11, H17, H18, H24, H25, H26, H27, MMM		
19	PAOZZ	5340011985455	19220	3-400-L (25)	PLATE, MOUNTING LATCH, DOOR L. H. FRONT & R. H. REAR.....	2	
					UOC:A11, A24, A25, A26, A27, B17, B18, B24, B25, C17, H11, H17, H18, H24, H25, H26, H27, MMM		
20	PAOZZ	5305002264831	80204	B1821BH031C150N	SCREW, CAP, HEXAGON H 5/16-18 X 1.50.	12	
					UOC:A11, A24, A25, A26, A27, B17, B18, B24, B25, C17, H11, H17, H18, H24, H25, H26, H27, MMM		
21	PAOZZ	5310012131333	78553	C183-012-4	PUSH ON NUT.....	8	
					UOC:A11, A24, A25, A26, A27, B17, B18, B24, B25, C17, H11, H17, H18, H24, H25, H26, H27, MMM		
22	PAOZZ	5340011958837	78947	HS49745	CLIP, RETAINING R. H.....	4	
					UOC:A11, A24, A25, A26, A27, B17, B18, B24, B25, C17, H11, H17, H18, H24, H25, H26, H27, MMM		
23	PAOZZ	5340011968158	78947	HS49746	CLIP-CLEVIS, ROD RET L. H.....	4	
					UOC:A11, A24, A25, A26, A27, B17, B18, B24, B25, C17, H11, H17, H18, H24, H25, H26, H27, MMM		
24	PAOZZ	5340012598600	19220	34-4974-51X	CATCH, FLUSH.....	1	
					UOC:A11, A24, A25, A26, A27, B17, B18, B24, B25, C17, H11, H17, H18, H24, H25, H26, H27, MMM		
25	PFOZZ	5340011978239	14557	U-6236	HANDLE, BOW FRONT.....	1	
					UOC:A11, A24, A25, A26, A27, B17, B18, B24, B25, C17, H11, H17, H18, H24, H25, H26, H27, MMM		

Current part is item (19) on diagram. Available at www.oshkoshequipment.com